



# HOSHIZAKI AMERICA, INC.

## SERVICE BULLETIN

**SB99-0011**

June 29, 1999

### **Subject: DCM Shutter Mechanism**

It has been reported from the field that the shutter lever # 9 has been coming loose from the solenoid assembly on new DCM-500 B models. An investigation has revealed that the wrong nuts were used in the assembly process. Evidently, we got our nuts mixed up. The N1 nuts should be the nylon self-locking type. Standard nuts were used on some assemblies and in some cases, lock tight sealant was used. If standard nuts were used without sealant, they will back off of the screw as the shutter operates. This problem could show up on any DCM-500 or DCM-750 model.

The part number for the correct lock nut is 7N22-0400. There are 3 on each shutter assembly. We ask that you order some of these nuts and if you go out on a DCM-500/750 call, check the shutter assembly. Replace the standard nuts with these to eliminate the possibility of a loose lever. If the call is warranty, note that the nuts were changed on the warranty form. See the

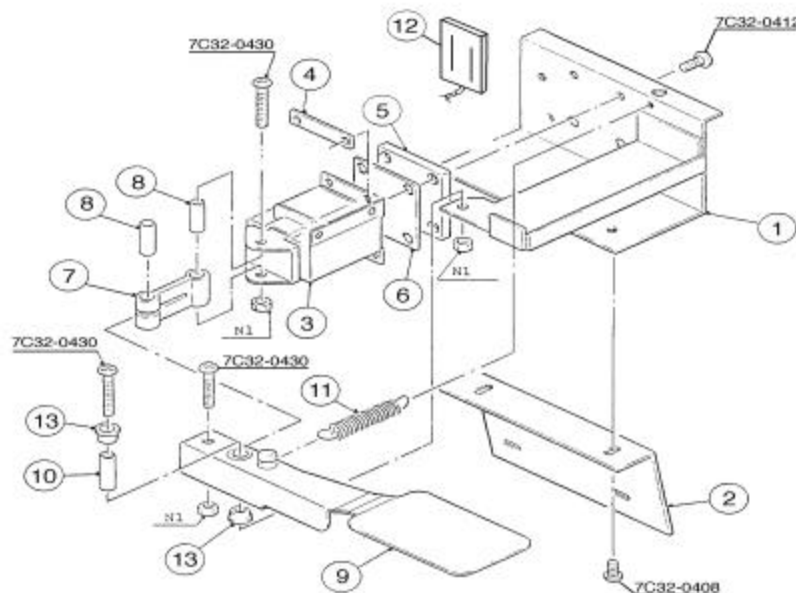

**drawing below for the three N1 nut locations.**