



# RM-65-HC

Glass Door Merchandiser with Swing Door



RM-65-HC  
10/03/25  
Item # 13463

## W x D x H

78" x 29.75" x 78"



RM-65-HC



RM-65-HC-BLK



RM-65-HC-WHT



## Dimensions / Capacity

Interior Storage Capacity (CF)	Three Section RM-65-HC 56.04 ft <sup>3</sup>
Overall Width x Depth	78" x 29.75"
Height	78"
Depth with Door Open	53.25"
Adjustable Shelves	5 per section
Shelf Dimensions (W x D)	(Center) 27.3" x 21.7" / (L&R) 22.4" x 21.7"
Crated Shipping Weight	800 lbs.
Crated Length x Depth x Height	81" x 32.25" x 84"

## Electrical / Refrigeration

Voltage	Three Section RM-65-HC 115/60/1
HACR Breaker	15.0 Amps
Electrical Connection (NEMA)	5-15P ⚡
Voltage Range	104-126
Ambient Temp. Range	60° to 86°F
Control Setpoint Range	28° to 40°F
Amperage	8.2
Energy Consumption (kWh/day) @ASHRAE	5.67
Approx. Nominal Compres. BTU/HR (HP)	(Left) 1217 (1/3HP) / (Right) 1217 (1/3HP)
Refrigerant / Charge Amount (oz)	R290/(4.10oz.) / R290/(4.10oz.)

## Options

- ☐ Organizer shelf
- ☐ Price tag holder
- ☐ Epoxy Shelf

Requires 2 sets of:

- ☐ 4" Casters (HS-5288)

## Warranty

3 Year - Parts and Labor on entire machine.  
5 Year - Parts on Compressor  
Valid in United States, Canada, Puerto Rico and U.S. Territories. Contact factory for warranty in other countries.

Item #: \_\_\_\_\_

Project: \_\_\_\_\_

Qty: \_\_\_\_\_

AIA#: \_\_\_\_\_

## Features

- ▶ Curved vertical corners with silver/black/white aluminum exterior provide enhanced product display
- ▶ Forced air evaporator for quick temperature pull down
- ▶ Energy saving hot gas loop on front edge of cabinet helps prevent condensation

- Listed under NSF/ANSI Standard 7 for the storage and/or display of packaged or bottled products.
- Large glass doors are energy efficient Low-E multi pane glass with locks
- Doors are standard with locks
- (5) white epoxy coated shelves per section with product stops are standard
- LED illuminated exterior graphic display
- Energy efficient vertical LED interior lights illuminate products on display
- Door is mounted on heavy duty hinges with self-closing mechanism
- Silver painted aluminum exterior with NSF approved white steel interior and stainless steel floor
- Time initiated automatic defrost
- Environmentally friendly CFC-Free Polyurethane insulation with cyclopentane blowing agent.
- Stainless steel shelf clips adjustable in 1/2" increments on anodized aluminum supports
- Refrigerant flow is controlled with a capillary tube
- 8 Foot cord and plug
- 2 inch leveling legs standard
- Exterior finish available in silver, white, and black

Capacity:

20 oz. bottles: 830

12 oz. bottles: 1926

Container Qty: 14

If GFCI is required, a GFCI breaker MUST be used in lieu of GFCI receptacle  
Hoshizaki reserves the right to change specifications without notice.



# RM-65-HC

Glass Door Merchandiser with Swing Door

RM-65-HC  
10/03/25  
Item # 13463

## FRONT VIEW

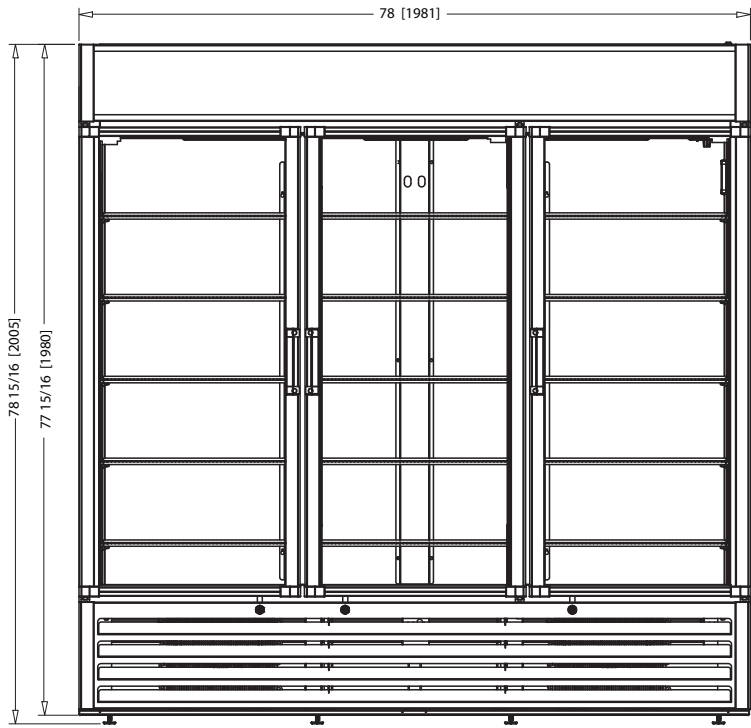

## SIDE VIEW

inch [mm]

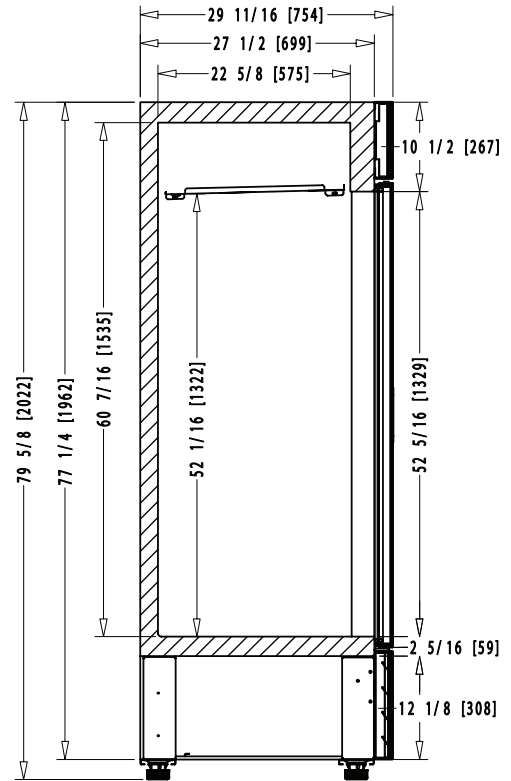

## PLAN VIEW

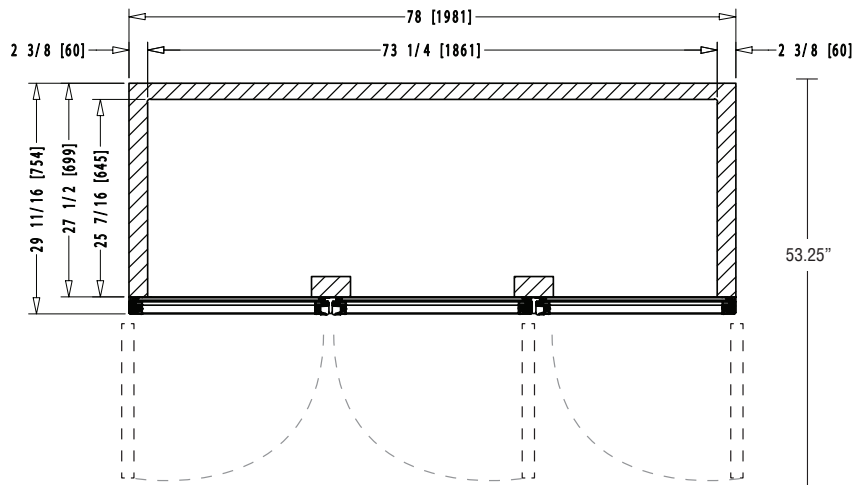

## HEADER DIMS

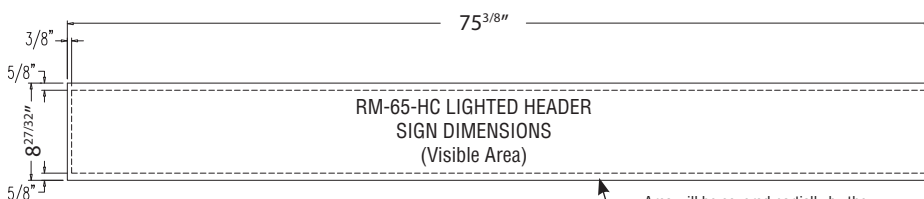

Note: Texts and important parts of the image should be within the visible area. The visible area is illustrated by dotted lines when it applies.

Area will be covered partially by the sign frame, but should have a bleed of graphics background.

### Graphic Requirements:

- 360 dpi resolution. Scale 1=1
- Graphics must be saved in photoshop (with layers) (or your sign company file type requirements)
- Colors for CMYK process
- Image with 1/4" of excess by side
- Include a full color print out

### Material Requirements:

- Thickness: 1/16" (1.5mm)
- Good- Acrylic/Pexiglass, Better - high impact acrysteel, acrylite SG Best- Super impact Lexan, Lexan SG Polycarbonate